

---

## Copper Lay in Lugs for Solar

---

### Copper Lay in Lugs for Solar

Conex Offers Copper Lay in Lugs Copper Lay in grounding lugs for solar panels and swimming pool applications.



Copper Lay in grounding lugs  
For Solar panels

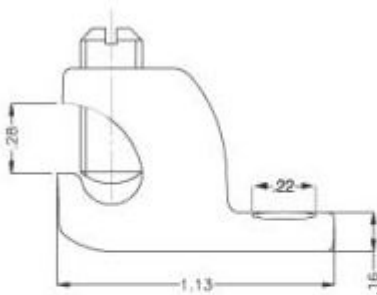

### Copper Lay in lugs Applications:

Solar Lay-In Grounding Lugs are the ideal choice for the quick installation of one continuous grounding conductor or as a jumper to multiple locations. Just unscrew the Stainless Steel set screw, lay in the cable, and re-tighten, making it easy to retrofit or repair. These are widely used for solar panels and swimming pool installations.

---

## **COPPER LAY IN LUG GROUNDING LUG FEATURES:**

---

- These Copper lugs are Tin plated copper for additional corrosion resistance
- For use with #4-14 cable
- Stainless steel slotted grub screw
- Suitable for direct burial and outdoor use
- Ideal for continuous grounding of solar PV panels
- Suitable for use with copper conductors only, solid or stranded

---

### **ADDEESS:**

Conex Bronze Fittings

### **CONTACTS:**

PHONE : 91 22 43449300

FAX : 91 22 22834046

EMAIL : [sales@conexbronze.com](mailto:sales@conexbronze.com)

[CONTACT US](#) | [BACK TO HOME PAGE](#)

### **KEYWORDS:**

**Copper Lay in Lugs, Copper grounding lugs ,Copper lugs with lay in feature, Tin plated Copper lugs, Tin plated Copper lay in grounding lugs,**